

PYRITE by bomma

13 PYRITE PENDANTS RECTANGULAR CHANDELIER

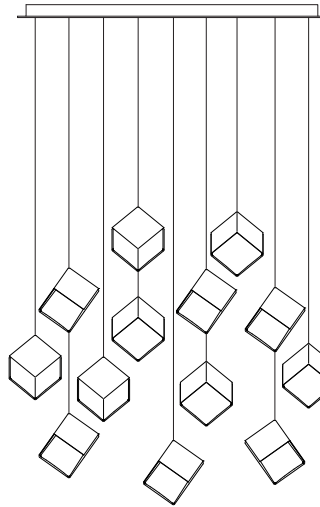
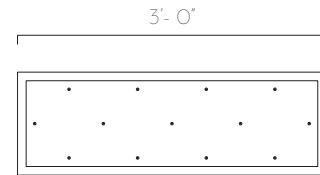

DESCRIPTION

The BOMMA collection was inspired by pyrite, the golden fire-stone in the shape of a perfect cube, while the silver version of the shade reflects its inspiration in salt crystals. By blowing a molten organic substance into a precise cold form, the skilled hands of our glassmakers create a unique light fixture of elemental, yet perfect shape.

The gleaming surface of this hand-blown crystal cube is enclosed from three sides by a polished metal component in either silver or gold tones.

The Pyrite Collection excels in both exceptional design and top-quality materials. Easily combined, it invites you to create your own unique lighting constellations.

Designed by
Studio Dechem

Category
Pendant Chandelier

TECHINCAL SPECIFICATIONS

Canopy Finish
Powder coated metal in Flat White/ Sparkle Silver

Canopy Size
36" x 12" x 1.5"H

Pendant Finish
Clear Crystal Glass with Polished Gold Top Cover

Pendant Size
7.2" x 8.2" x 8.9"

Total Drop
5'H + 2' extra wire for adjustment

Bulb
Dimmable LED G4 -2W - 12V, 120 lm

Recommended Dimming Switch
Lutron CTCL-153PD/ Lutron Pro

Transformer:
Magnitude E60R12DC - 60W 12VDC - Dimmable - Class 2 LED Driver
Input: 120V
Output: 12V

Electrical Outlet needed: 1

Note: All Bomma products are hand-made from mouth-blown lead-free crystal. Therefore any small bubbles, non-melts and irregularities in the glass are both proof and a characteristic feature of this traditional craft.